

FAAC-INFO

TECHNICAL SERVICES DEPT.

Date: May 5, 2005	Vol. # 012
Subject: 400/422 Swing Gate Operators	Reason For Info: Modifications

Description:

FAAC is proud to introduce some modifications to our model 400/422 Swing gate operators.

These modifications are as follows:

- 1) * The locking cap has been changed to prevent the home owners from being able to turn the key too far counterclockwise compromising the key cylinder. This modification also improves sealing from moisture leaking into the operator's oil tank. I have attached a picture to show the new style manual release system.
- 2) The valve body has had a pressure relief spring added to it in the event a customer uses the wrong oil and causes a lock up situation. This relief spring also makes it so that during installation, the installer does not have to set the pressures different from one another.
- 3) The valve body has also been modified to incorporate a new inlet valve. This inlet valve allows a more even flow of oil in the hydraulic system. This will result in identical opening and closing speeds.

We first sent out notification of these changes in November of last year.

The time has now come that in the next few months these modifications are going to be sent out because our old stock is deflating and the new modified operators are now being manufactured and being sent to us from Italy.

See the attached pictures for further explanations of the new style manual release.



400/422 New Style Locking Cap Information

Figure 1 shows the key access. Once the key is turned counterclockwise (1/4 turn) the hinged cover lifts upwards to reveal the manual release knob. The knob is turned counterclockwise to put the operator into manual release mode (gate movable by hand) and then the knob is turned clockwise to reengage the operator (gate not moveable by hand). The manual release knob has the lock/unlock positions pictured on it with arrows showing the direction to turn it.

The pressure screws (figure 3) are under the manual release knob and need to be set before the manual release knob is installed. During the initial operator installation the knob is in the skin (hardware) pack and needs to be installed (figure 3) after the pressures are adjusted.

Oil is now added and/or checked through the rear flange. See figure 4.

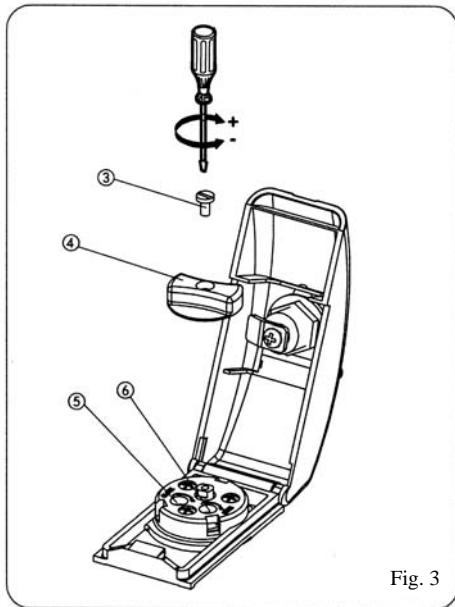
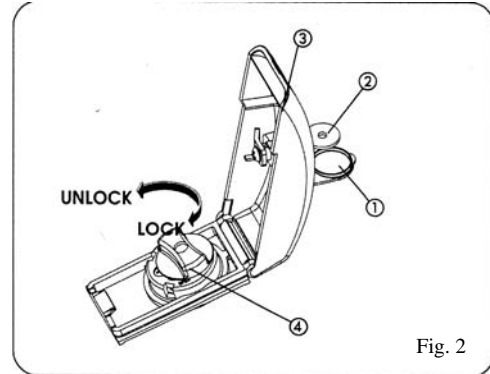
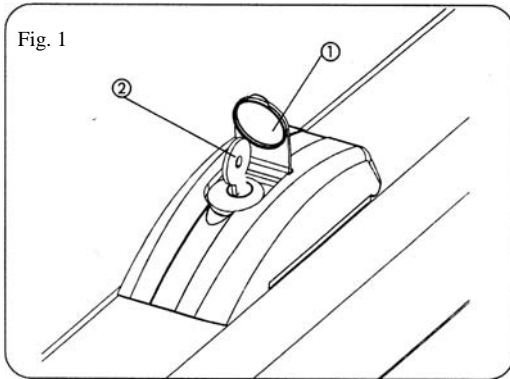

Fig. 4

